

- TIMING UP TO 59 MINUTES 59 SECONDS
- 46 MM STAINLESS STEEL CASE
- UNI-ROTATIONAL BEZEL RING
- MIYOTA OS20 MOVEMENT
- SCREW DOWN CROWN
- MINIRAL CRYSTAL
- SILICONE STRAP
- CHRONOGRAPH
- 24 H DISPLAY
- 20 ATM
- DATE

## MUGELLO MANUAL

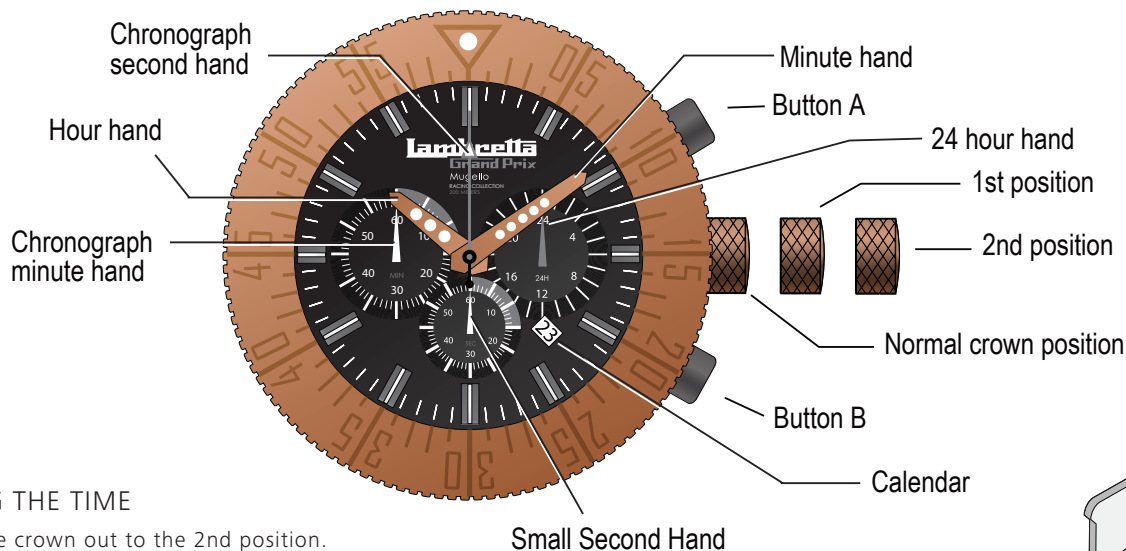

### SETTING THE TIME

1. Pull the crown out to the 2nd position.
2. Turn the crown to set hour and minute hands.
3. When the crown is pushed back to the normal position, small second hand begins to run.

### SETTING THE DATE

1. Pull the crown out to the 1st position.
2. Turn the crown counter-clockwise to set the date.  
\*If the date is set between the hours of around 9:00 PM and 1:00 AM, the date may not change on the following day.
3. After the date has been set, push the crown back to the normal position.

### USING THE CHRONOGRAPH

This chronograph is able to measure and display time up to maximum of 59 minutes 59 seconds.

1. The chronograph can be started and stopped each time button "A" is pressed.
2. Pressing button "B" resets the chronograph and the chronograph second hand and chronograph minute hand return to zero position.

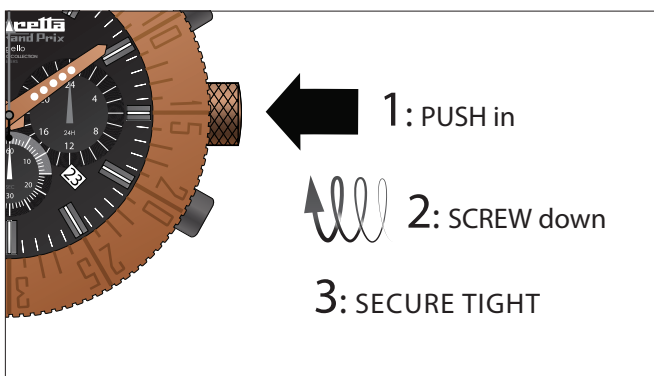

Remove the **plastic stopper** underneath the crown. Then push the crown back in to activate the battery.

**PUSH** in the CROWN properly before you expose your watch to moisture. Do **NOT** push the Reset or the Start/Stop Buttons underwater.

### MEASURING TIME WITH THE CHRONOGRAPH



### CHRONOGRAPH RESET (INCL. AFTER REPLACING BATTERY)

This procedure should be performed when the **chronograph second hand does not return to zero position** after the chronograph has been reset, and including after the battery has been replaced.

1. Pull the crown out to the 2nd position.
2. Press button "A" to set the chronograph second hand to the zero position. The chronograph hand can be advanced rapidly by continuously pressing button "A".
3. Once the hand has been zeroed, return the crown to the normal position.